

# P2M Bridge Study-Working Mtg 080708



## Introduction of Selection Criteria

# P2M Bridge Study-Working Mtg 080708

## **THIS STEP**

**Selection/Screening- “All Types” to “Many Types”**

**Engineering- “Pass-Fail”**

**Architectural- Opportunities and Challenges**

## **NEXT STEP**

**Selection/Screening- “Many Types” to “Some Types”**

**Engineering-Performance of types against Engineering criteria**

**Architectural- Performance of types against Aesthetic criteria**

## **Selection Criteria- Introduction**

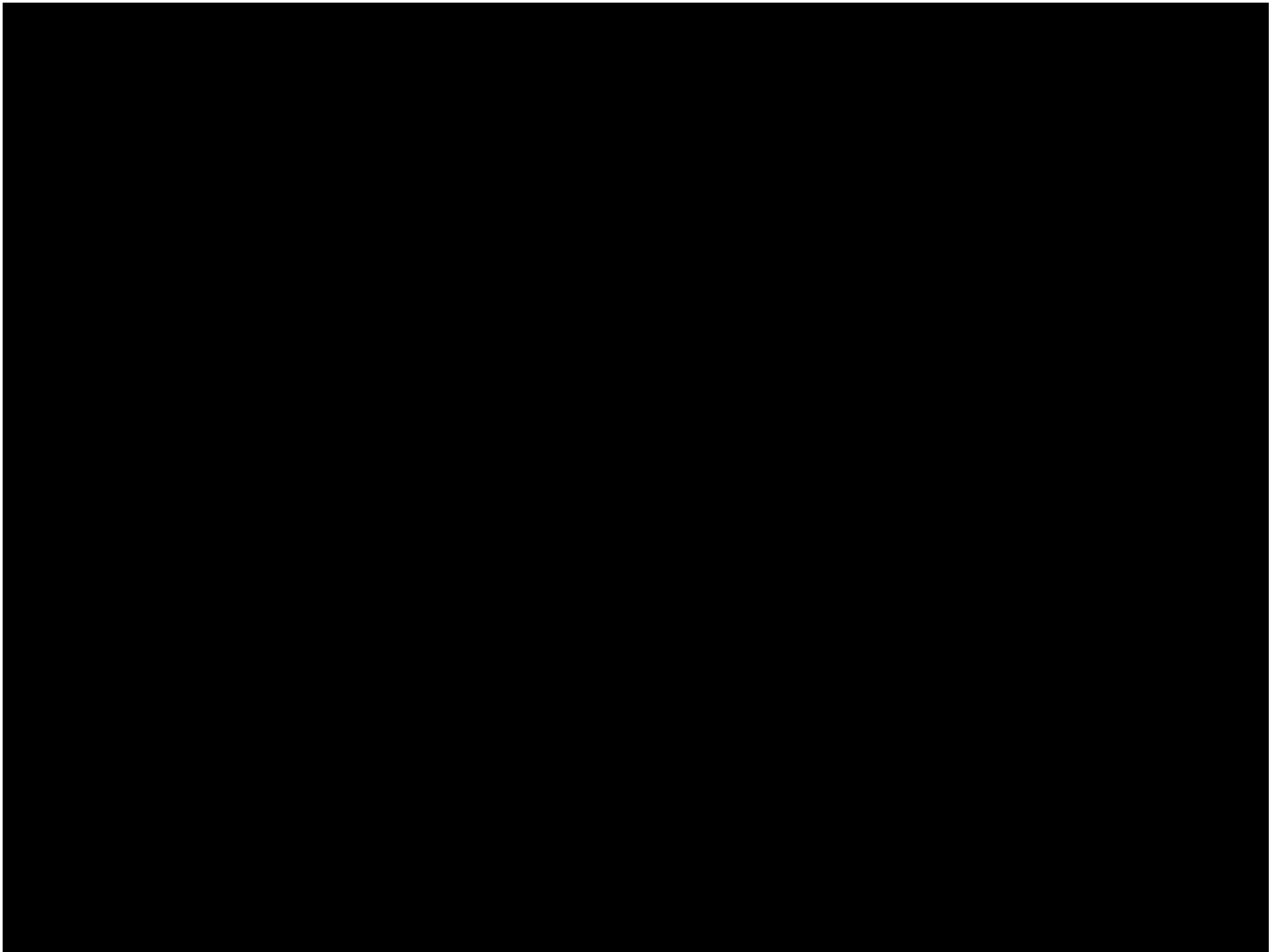

# P2M Bridge Study-Working Mtg 080708



## Baseline Assumptions

# P2M Bridge Study-Working Mtg 080708

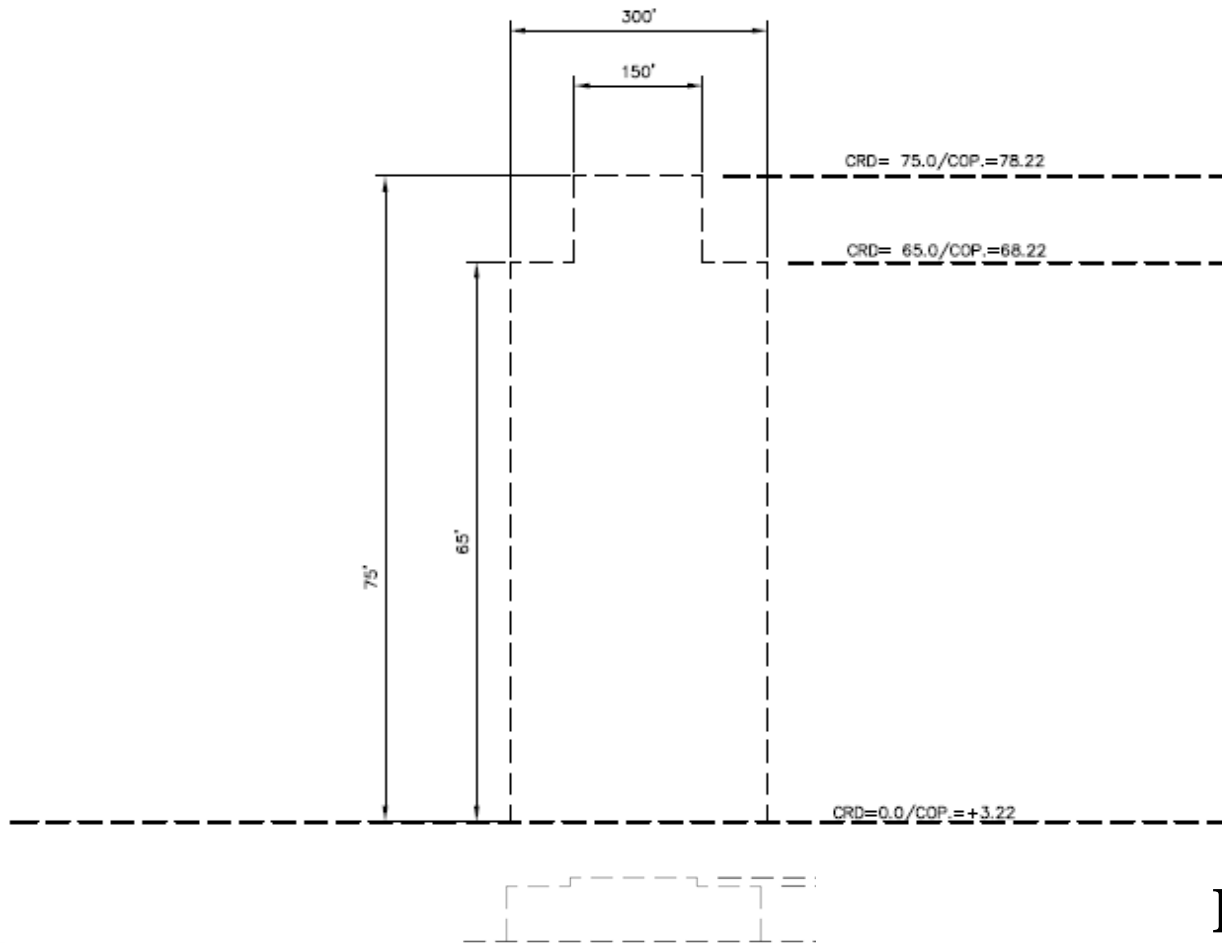

75' V. for 150' H.

65' V. for 300' H.

**Baseline Assumptions**  
**Clearance Diagram**

# P2M Bridge Study-Working Mtg 080708

Vessel Data				
Company Name	Vessels	Standard Vert Ctr (ft) aka "Vessel Height"	Proposed 75' Ctr (CRD)	% of Days of Usable Level
Johns Landing Boat Club	Various vessel	12	75	100.0%
Larson's Marine Services	Tugboat	20	75	100.0%
City of Portland-Fire and Rescue	Fireboat Campbell	20	75	100.0%
Shaver Transportation	Vancouver Tug	22	75	100.0%
Portland Spirit	Outrageous	22	75	100.0%
Portland Rose	Portland Rose Sternwheeler	30	75	100.0%
Ross Island Sand & Gravel	Rossdale Tug	32	75	100.0%
CMPB; Larson's Marine Services	Boat house	38	75	100.0%
Combined Forestry & Marine Svcs Inc	Floating homes	40	75	100.0%
Portland Spirit	Willamette Star	40	75	100.0%
Portland Spirit	Portland Spirit	44	75	100.0%
Portland Spirit	Crystal Dolphin	44	75	100.0%
Zidell Marine Corp	Barges	50	75	100.0%
Shaver Transportation	Clearwater Tug	50	75	100.0%
Combined Forestry & Marine Svcs Inc	Tugboats	50	75	100.0%
Lindblad Expeditions/Nati Geographic	Sea Bird	53	75	99.9%
Shaver Transportation	Willamette Tug	55	75	99.9%
Shaver Transportation	Deachutes Tug	55	75	99.9%
Shaver Transportation	Cascade Tug	55	75	99.9%
Lindblad Expeditions/Nati Geographic	Sea Lion	55	75	99.9%
Portland Spirit	Columbia Gorge	58	75	99.6%
Combined Forestry & Marine Svcs Inc	Various crane barges	60	75	99.9%
Ross Island Sand & Gravel	Dauby Tug	65	75	90.3%
Combined Forestry & Marine Svcs Inc	LCI 713	65	75	90.3%
Oregon Maritime Museum - non-profit	Sternwheeler Steamer Portland	65	75	90.3%
Lavine A Linker	Sailboat Prospector	65	75	90.3%
Bernard's Moorage	Various vessels	65	75	90.3%
Promise Charters LLC	Sailboat Promise	68	75	65.0%
Zidell Marine Corp	Crane barge	75	75	NA
Larson's Marine Services	Crane Barge	75	75	NA
Grays Harbor Historical Seaport Authority	Headan Chieftain	70	75	23.2%
Ross Island Sand & Gravel	Derrick barge/Dredge	79	75	NA
Grays Harbor Historical Seaport Authority	Lady Washington	80	75	0.0%
Shaver Transportation	Crane Barge	110	75	0.0%

## River User Survey and River Levels

## Clearance Diagram

# P2M Bridge Study-Working Mtg 080708

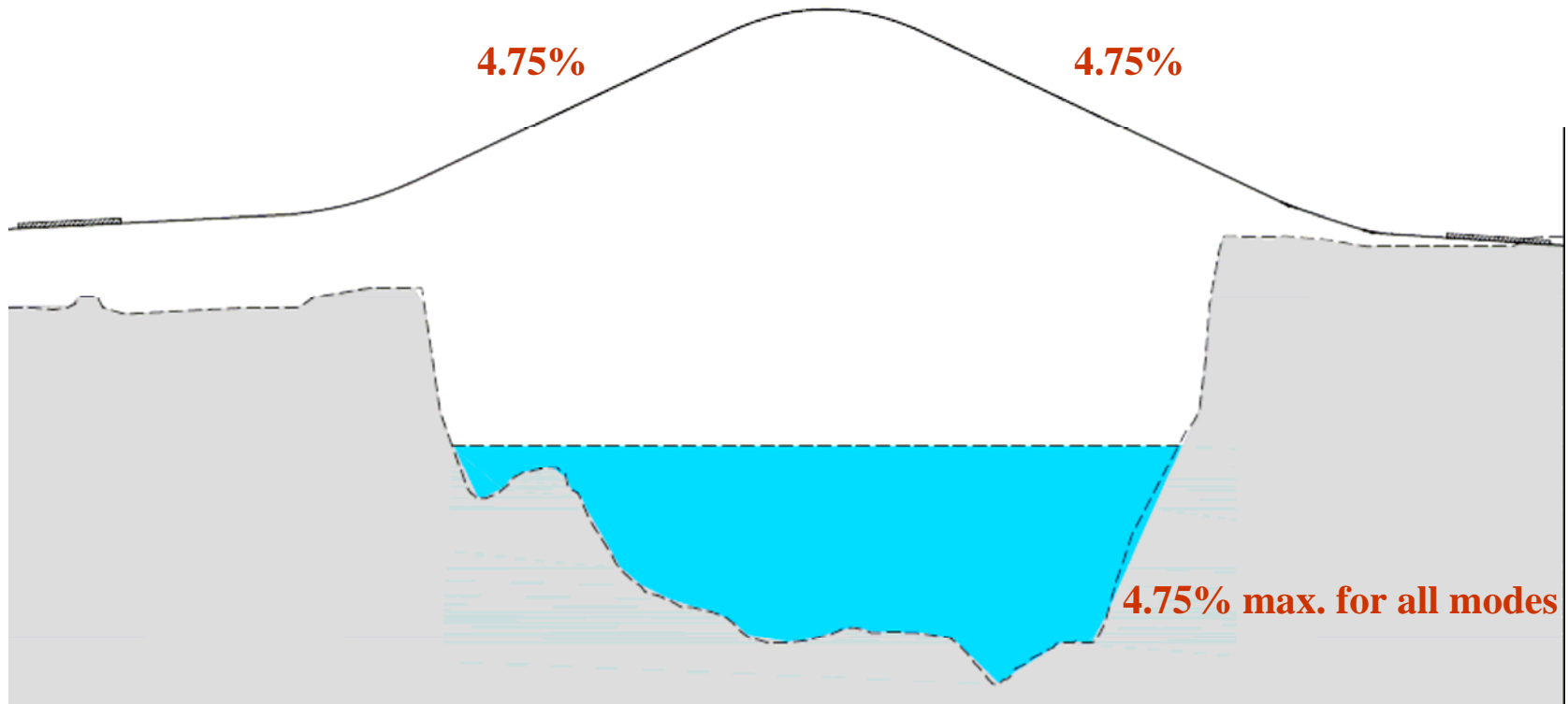

## Baseline Assumptions Grades



# P2M Bridge Study-Working Mtg 080708

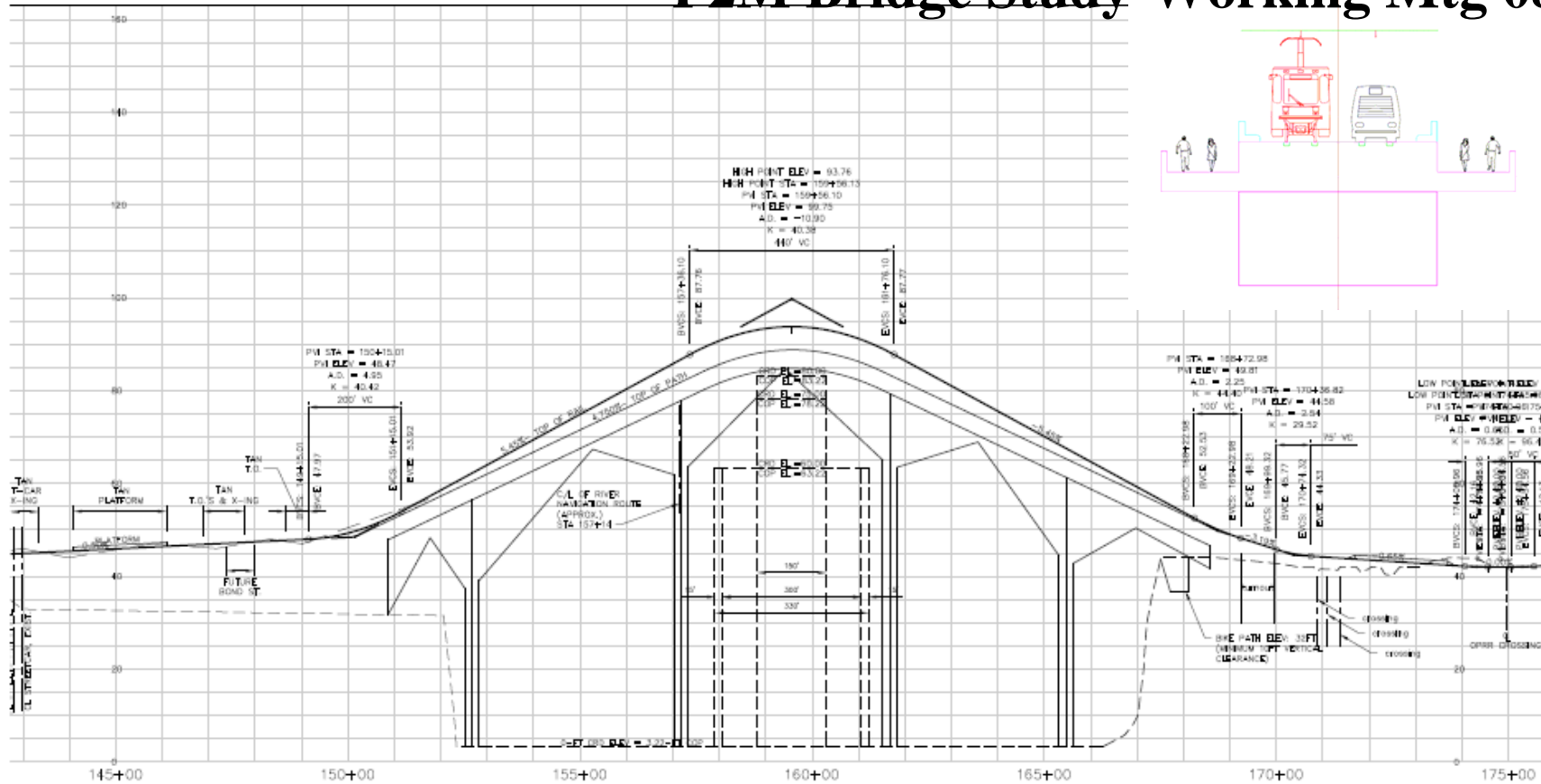

**ALTERNATIVES TESTED-Different Grades**  
**Grades**

# P2M Bridge Study-Working Mtg 080708

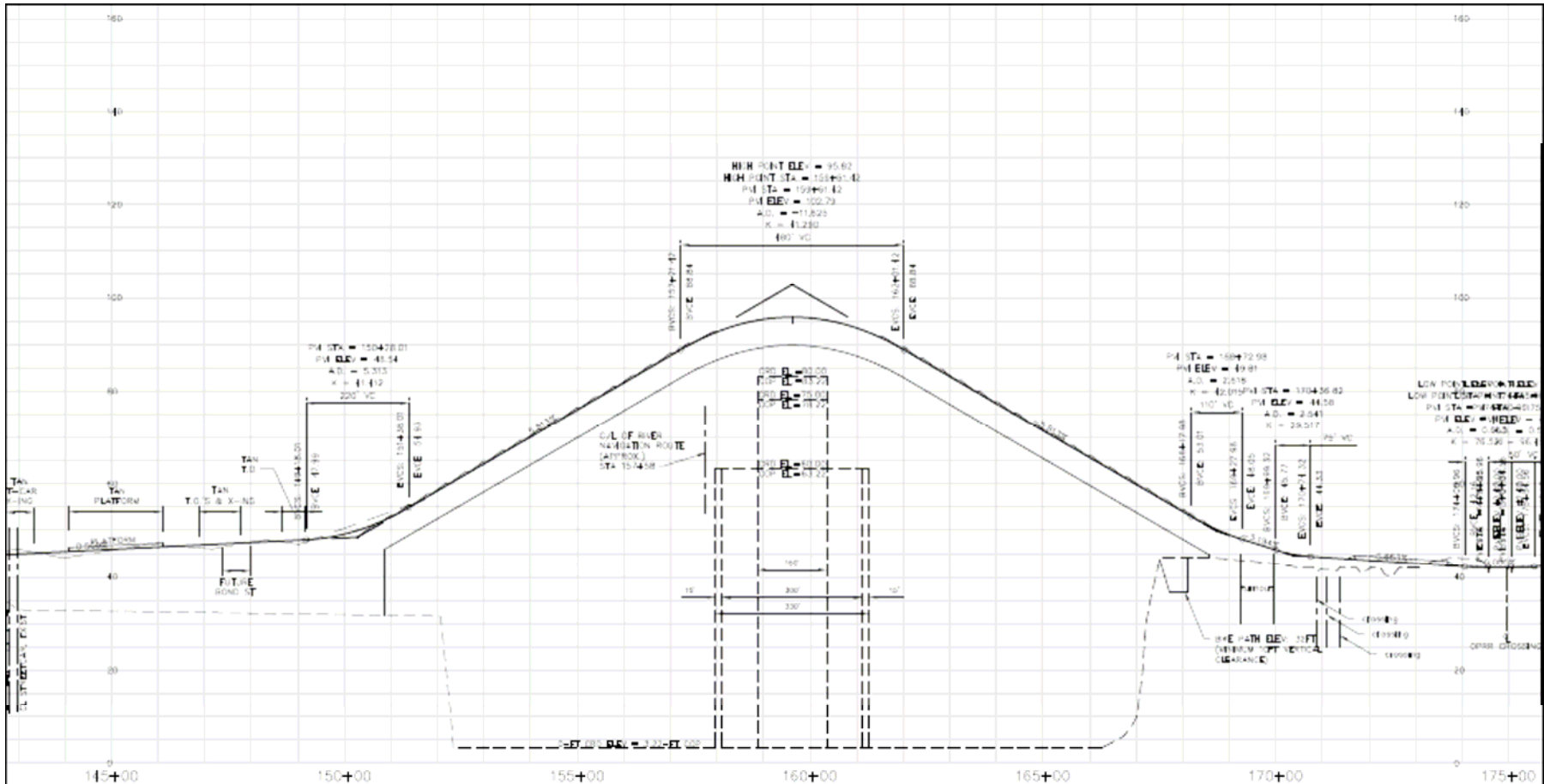

## ALTERNATIVES TESTED-Ramps and Landings Grades

# P2M Bridge Study-Working Mtg 080708

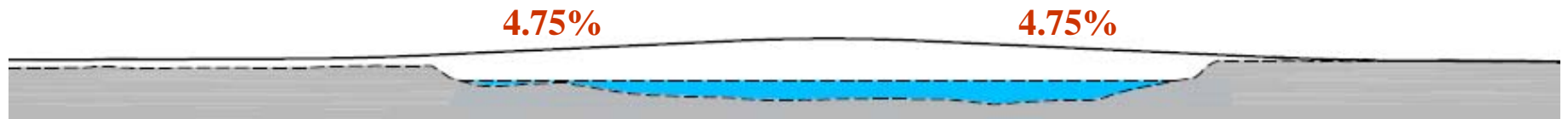

4.75% max. for all modes

**Baseline Assumptions**  
**Grades-No Vertical**  
**Exaggeration**

# P2M Bridge Study-Working Mtg 080708

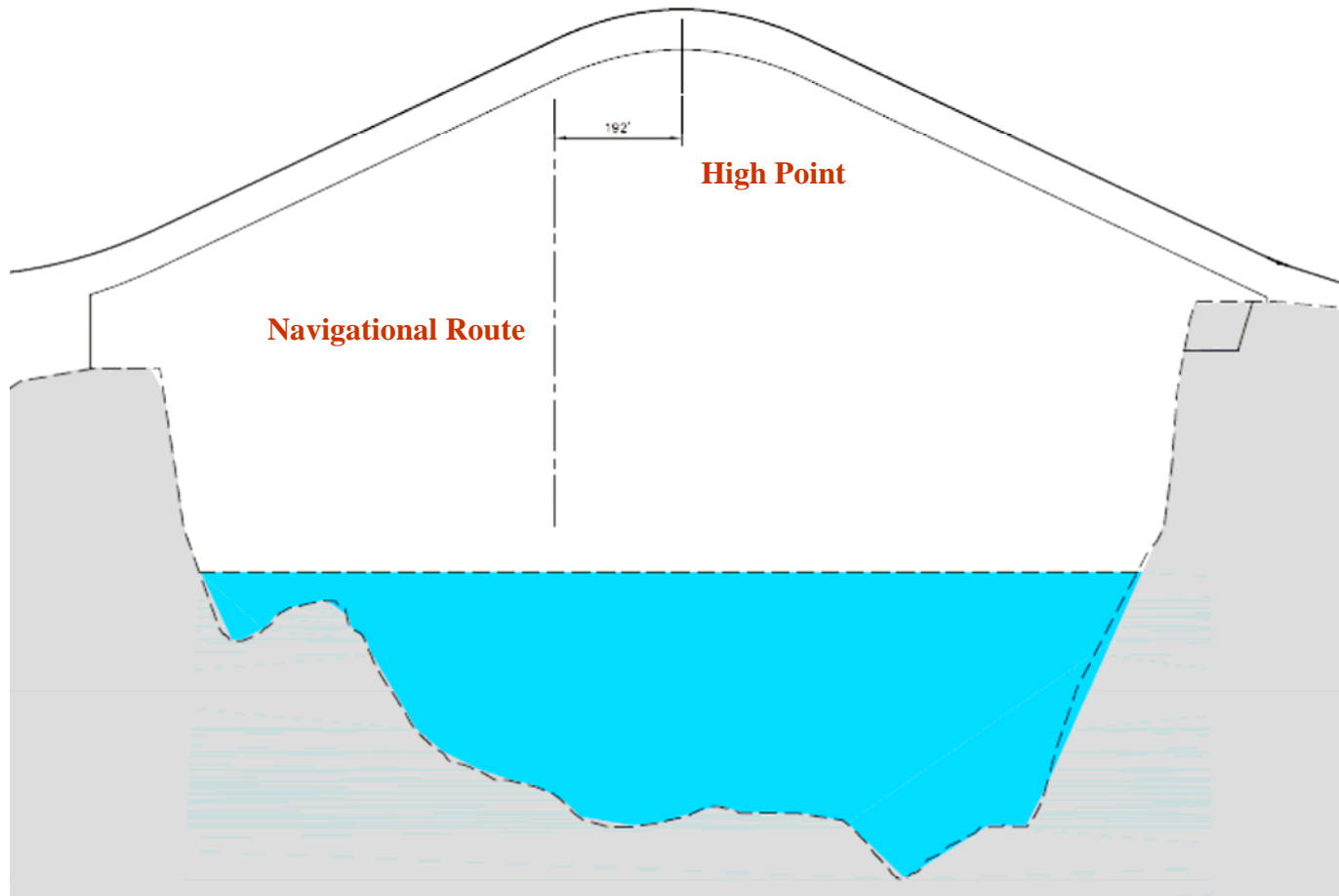

**Not In Same Location**

**Baseline Assumptions  
Bridge High Point and  
Navigational Route**

# P2M Bridge Study-Working Mtg 080708

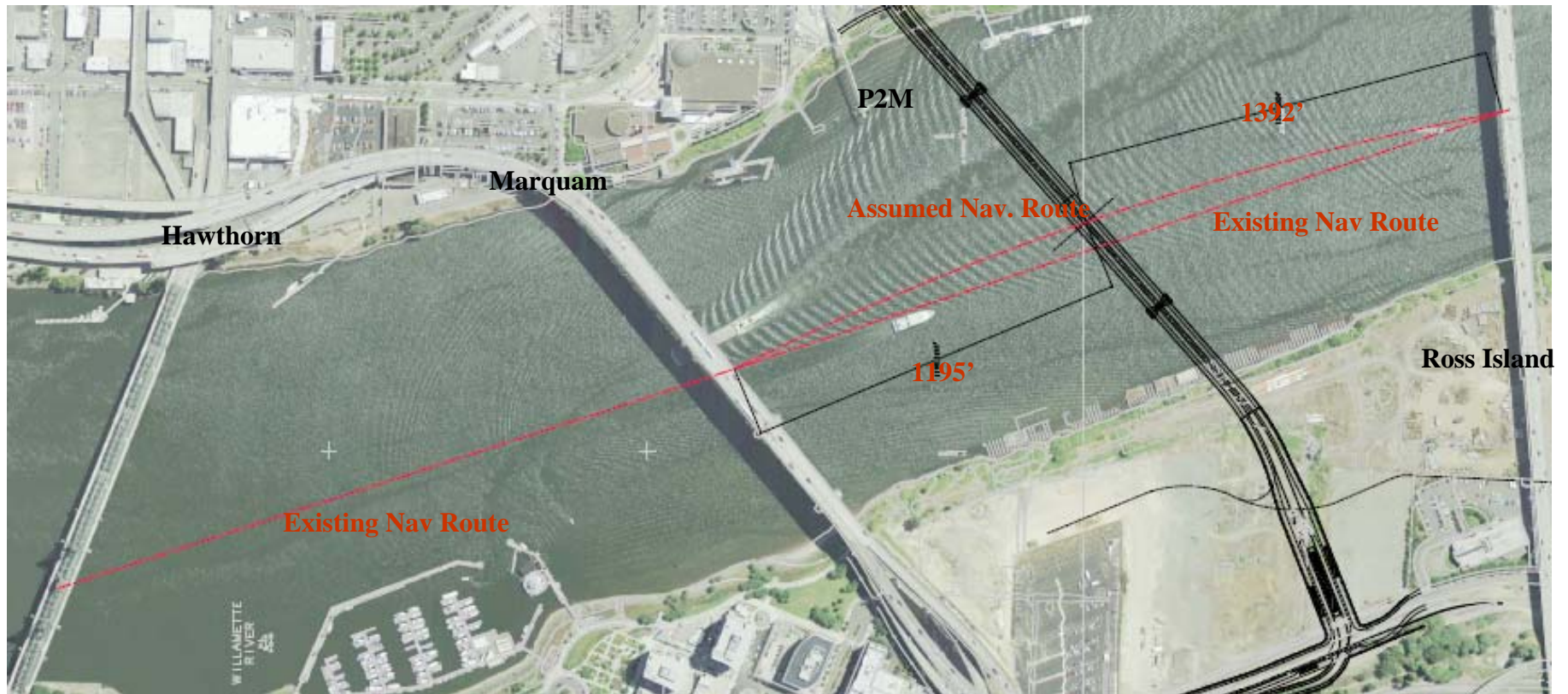

**Not In Same Location**

**Baseline Assumptions  
Bridge High Point and  
Navigational Route**

# P2M Bridge Study-Working Mtg 080708

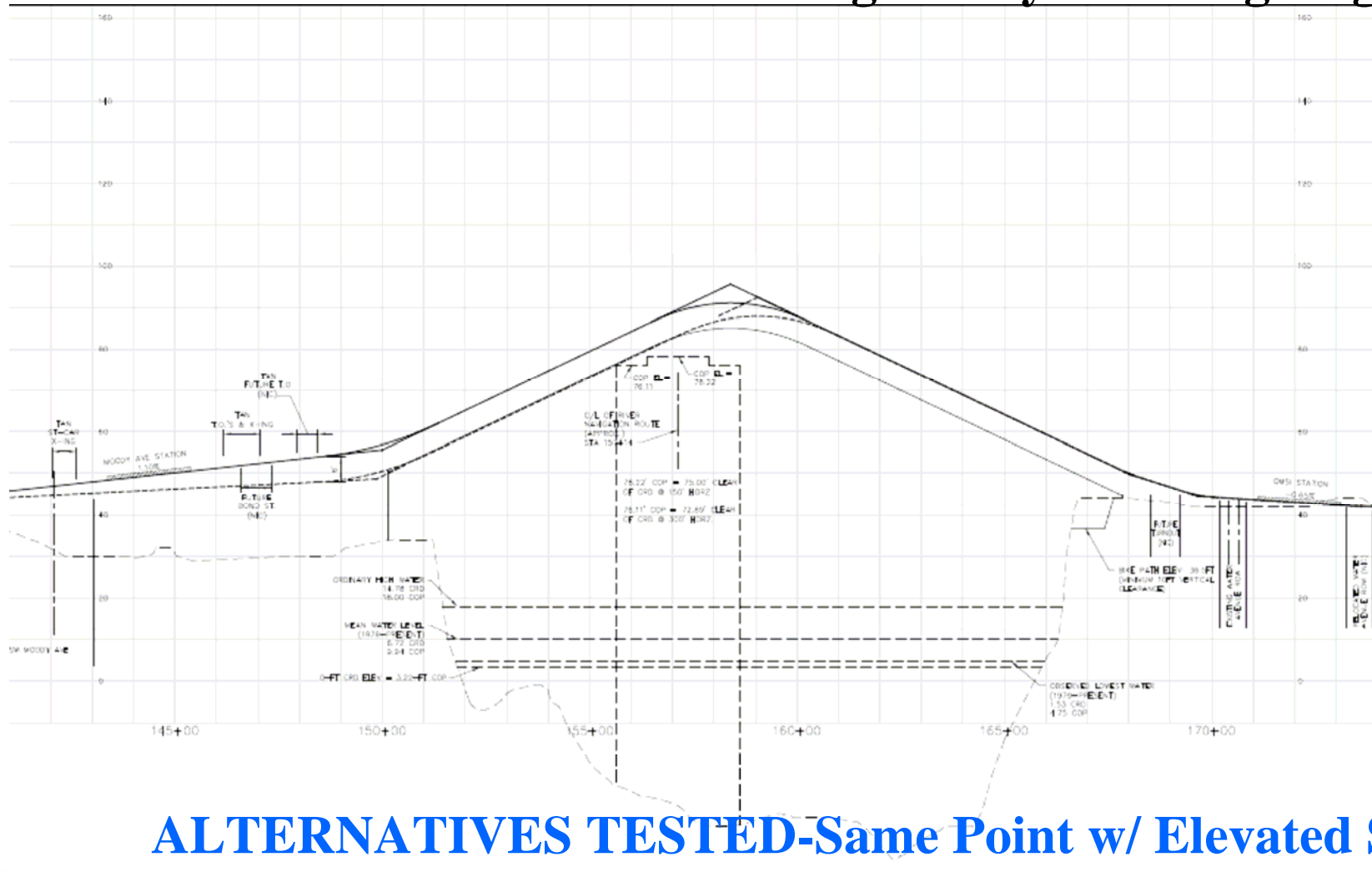

**ALTERNATIVES TESTED-Same Point w/ Elevated SWF**  
**Bridge High Point and Navigational Route**

# P2M Bridge Study-Working Mtg 080708

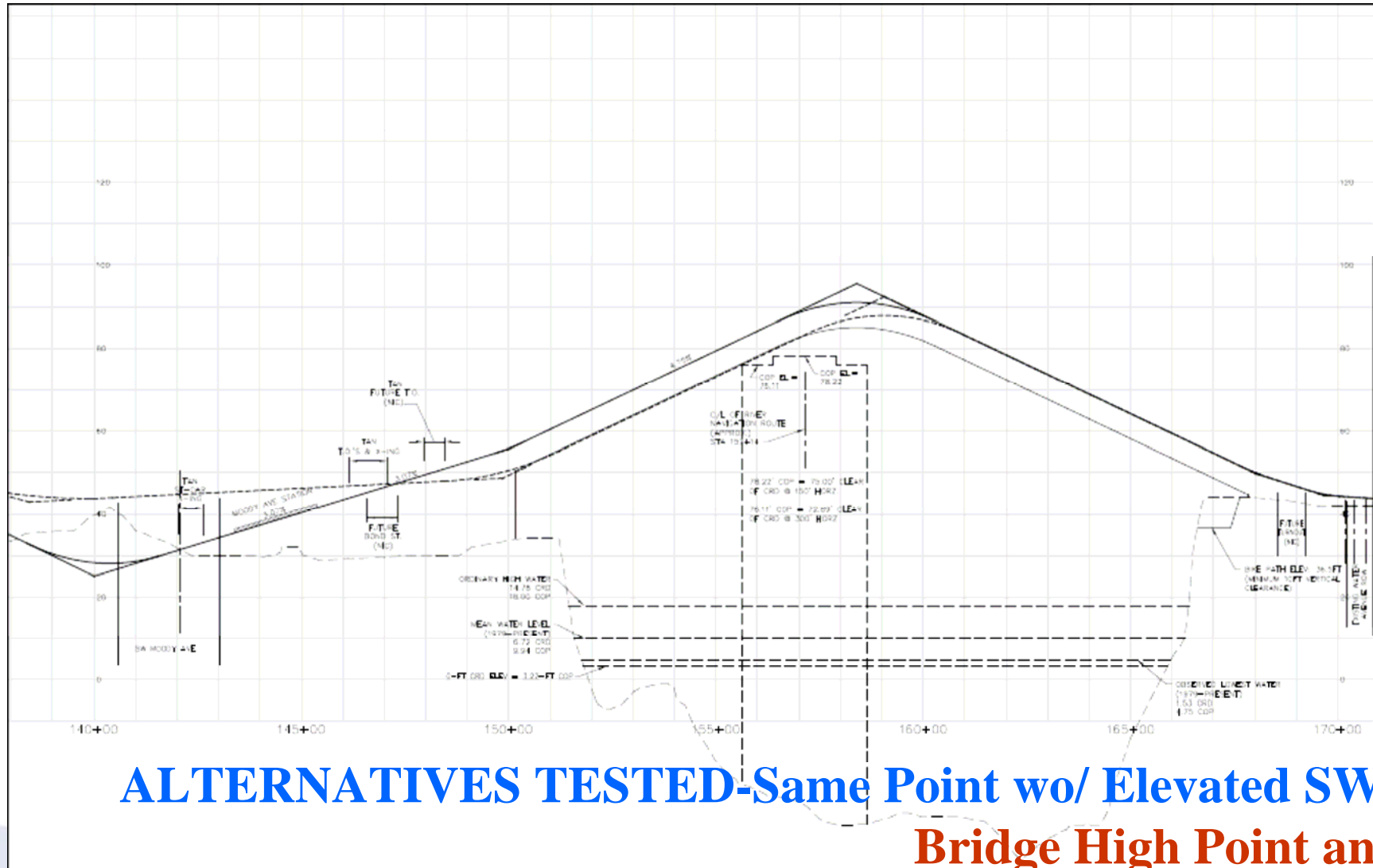

**ALTERNATIVES TESTED-Same Point wo/ Elevated SWF**  
**Bridge High Point and**  
**Navigational Route**



# P2M Bridge Study-Working Mtg 080708

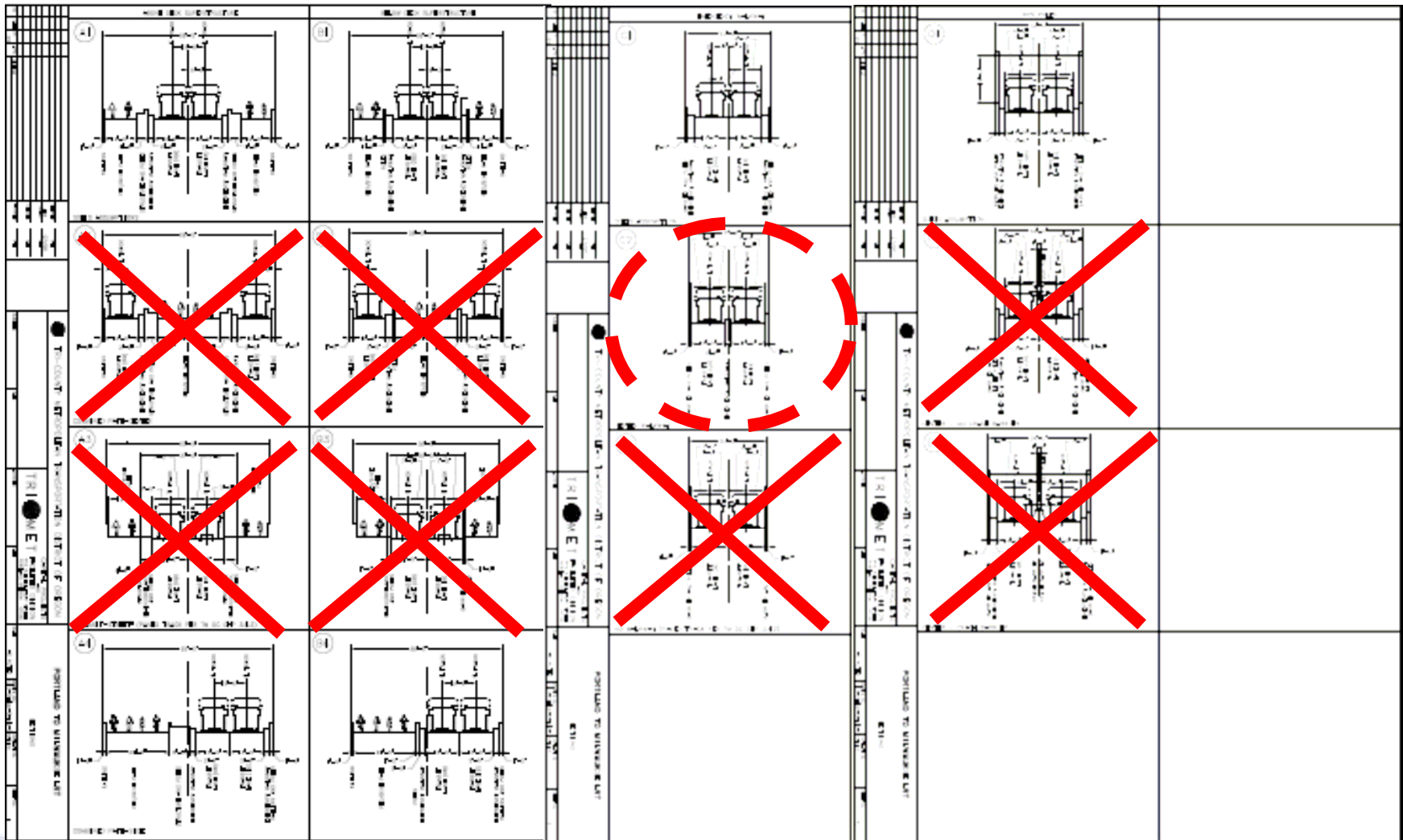

## Transit Component Alternatives

### Section Width

# P2M Bridge Study-Working Mtg 080708

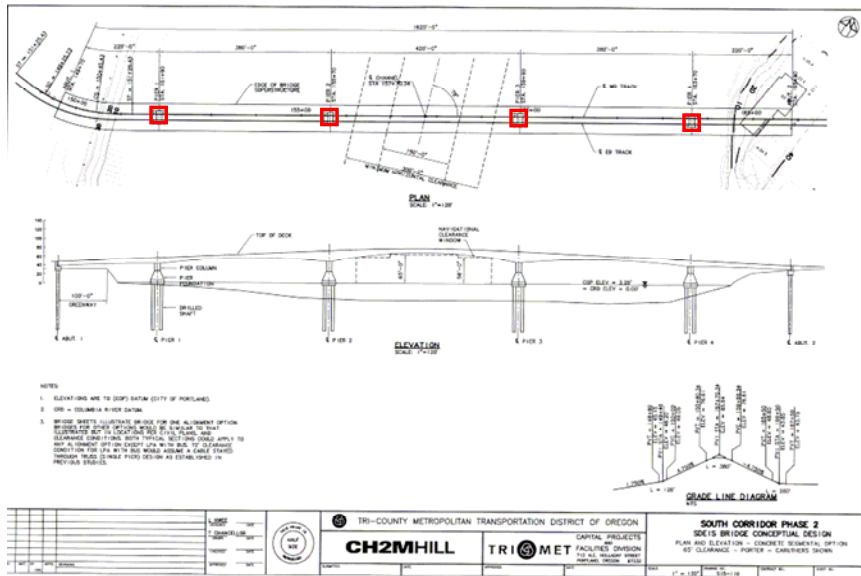

SDEIS-Concrete Segmental

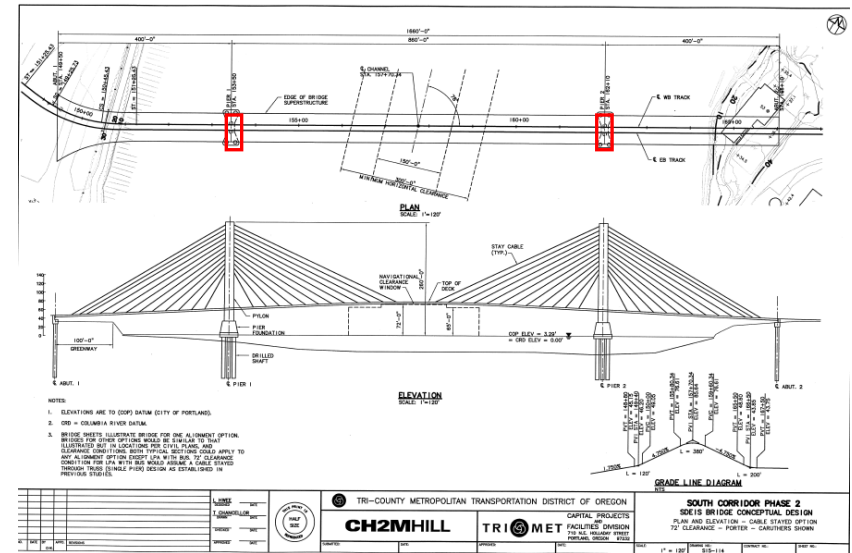

SDEIS-Cable-Stayed

4 (maximum)

**Baseline Assumptions**  
**Number of In-Water Piers**

# P2M Bridge Study-Working Mtg 080708

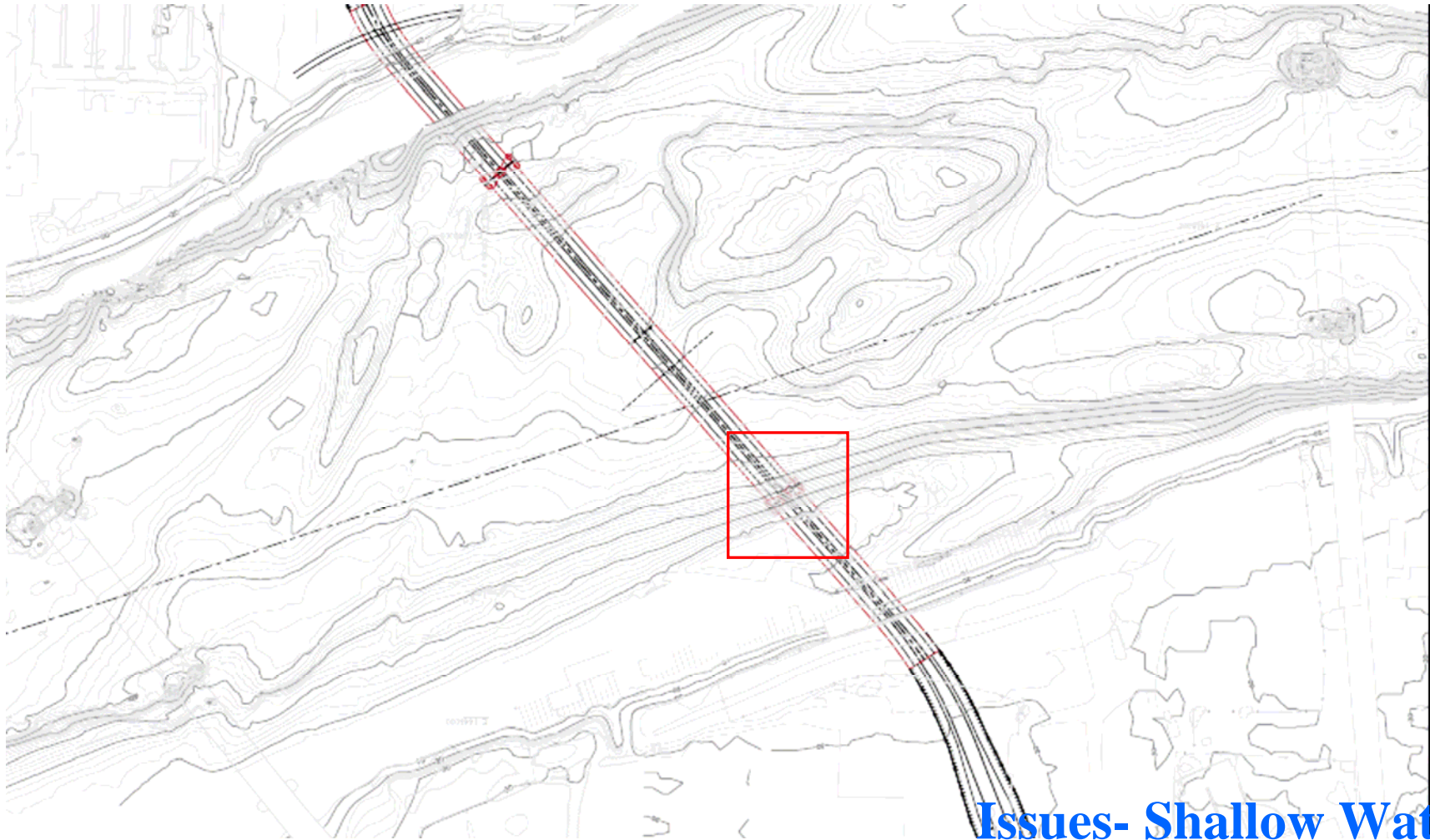

**Issues- Shallow Water**

**Number of In-Water Piers**



**Portland – Milwaukie**

**LIGHT RAIL PROJECT**